



FAMILY DOLLAR SITE DESIGN

Goffstown, NH

CLIENT

JDH Capital
Contact: Joe Mountjoy
Phone: (704) 496-7178

LOCATION

690 Mast Road
(Former Burger King)
Goffstown, NH

DESCRIPTION

This project includes demolition of the existing building and parking lot while maintaining runoff patterns on and around the site. The new 8,320 s.f. Family Dollar store is located on the 1.21 acre former Burger King Site at 690 Mast Road. The new store will be 2,886 square feet larger than the former Burger King building and will be set back further from Mast Road. The design will be more refined than a typical Family Dollar store and will incorporate a newer

looking façade utilizing brick. CLD’s responsibilities includes boundary, topographic, & ALTA surveys of the existing conditions, demolition plans, Site Layout, Grading, Utility & Storm water design, landscaping plan, site distance and Traffic impact determinations & Planning Board Site Plan Approval. Major challenges included reducing offsite runoff to reduce downstream drainage issues & providing a layout to properly circulate a full size WB67 tractor trailer on the limited sized parcel.

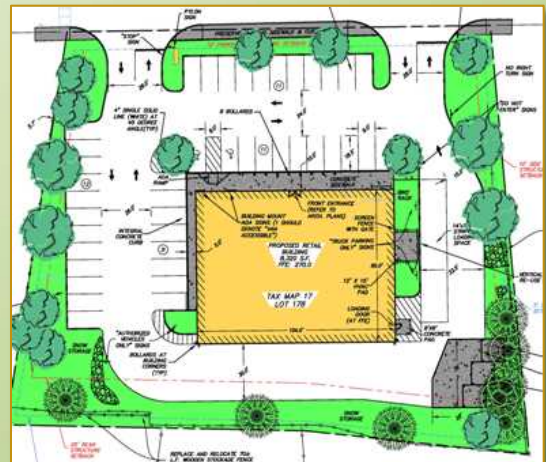

- Surveying Services
- Soils and Wetlands Mapping
- Civil/Site Services
- Site Design
- SWPPP and Environmental Permitting