

## CLIENT

NH Association of Realtors  
115A Airport Road  
Concord, NH 03301

## LOCATION

115A Airport Road  
Concord, NH

## DESCRIPTION

The NH Association of Realtors wanted to expand their existing facility on Airport Road and were looking to create a larger office facility and parking field. CLD performed a boundary and topographical land survey of the existing property. The existing site includes a smaller office building, parking field and an underground stormwater infiltration system. The stormwater management system appeared to be undersized as the client was experiencing flood activity during large storm events. The challenge was to create a design to accommodate the construction of a three-story office building including nearly 24,000 sf of office space and eighty-three parking spaces meeting the City's dimension standards. Cross access from the abutting property to the north was also to be maintained. A significantly larger underground infiltration system, was designed to meet local and state regulations, and was designed to adequately infiltrate the 100-year storm event to help eliminate any future flooding of the parking field. Coordination with the lighting designer, private utility owners, landscape architect and building architect further enhanced and completed the design plans for local approval.

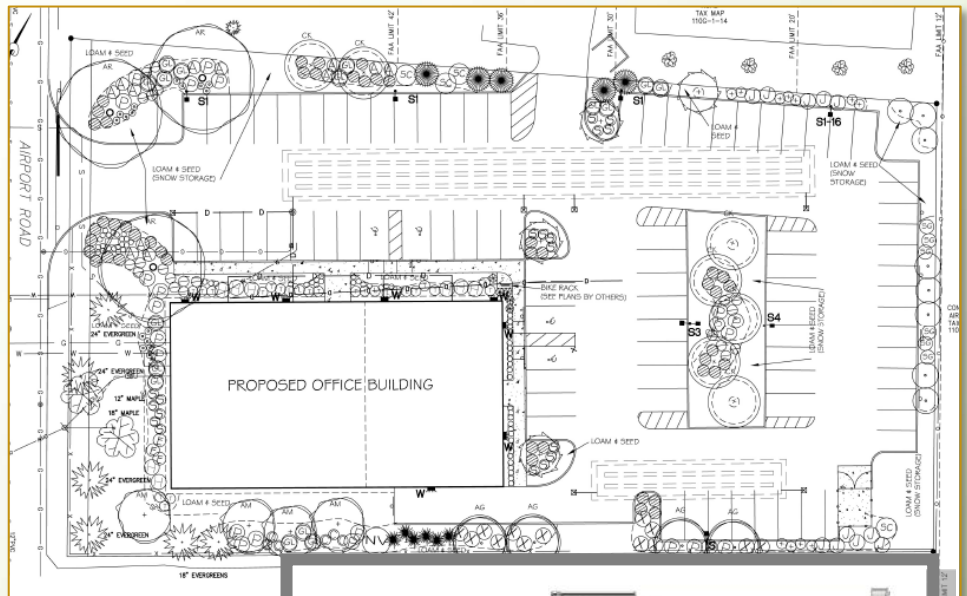

- **Boundary & Topographic Survey**
- **Site Plan Design**
- **Underground Stormwater Management Design**
- **Grading Design**
- **Private Utility Coordination**
- **Municipal Utility Connection**
- **Erosion & Sediment Control**
- **Planning Board Approval**
- **Landscape Architect Design Coordination**
- **Building Architectural Coordination**

utility owners, landscape architect and building architect further enhanced and completed the design plans for local approval.